

PRODUCT CATALOG

TABLE OF CONTENT

WELCOME _____	1
TABLE OF CONTENT _____	2
MC-5A _____	3-4
MY-10A _____	5-6
MG-15P _____	7-8
MT-15A _____	9-10
MT-20A _____	11- 12
MT-25A _____	13-14
MG-25A _____	15-16
MG-25P _____	17-18
MG-25S _____	19-20
MG-40A _____	21-22
MG-40D _____	23-24
MG-40P _____	25-26
MG-40S _____	27-28
MG-50A _____	29-30
MG-50D _____	31-32
MG-50P _____	33-34
MG-80A _____	35-36
CONTACT US _____	37

MC-5A

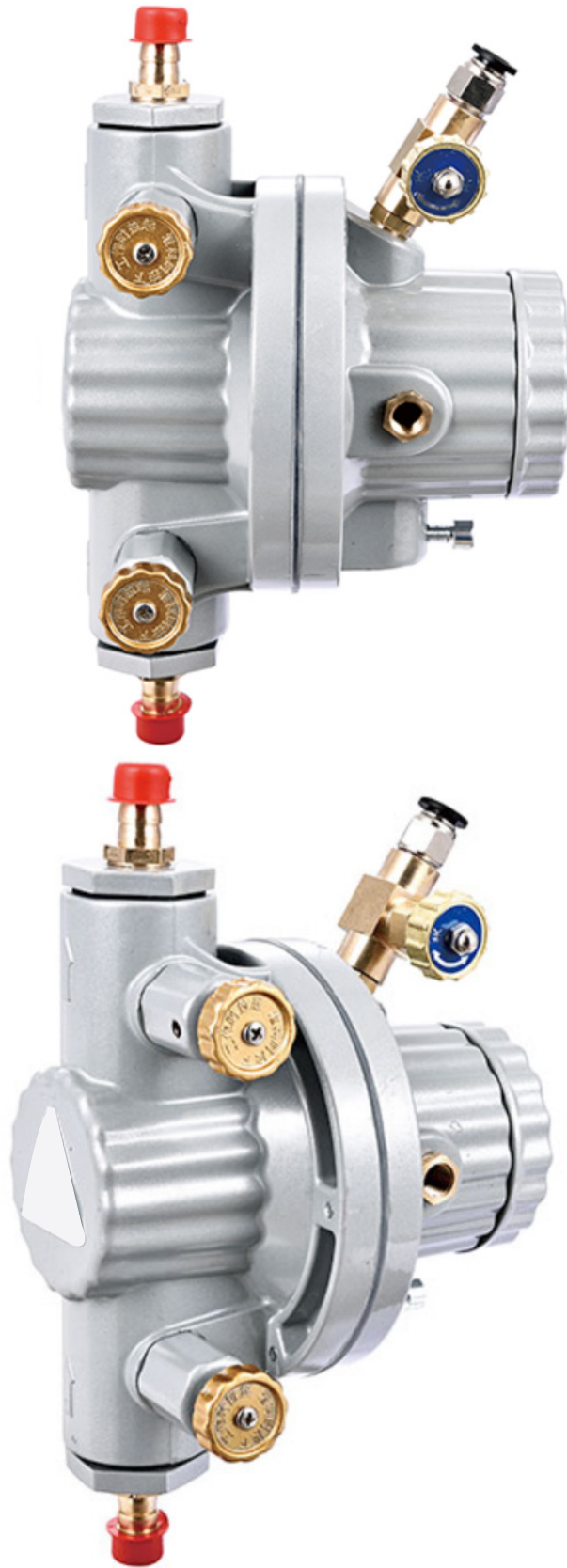

AIR OPERATED SINGLE DIAPHRAGM PUMP

3/8" Aluminium / PTFE

MC-5A

Technical Data

Capacity (Max)	: 10 l/min
Suction lift (Max)	: 4 m
Disc. pressure (Max)	: 0.5 Mpa
Solid size pass (Max)	: 2 mm
Air pressure (Max)	: 0.2 - 0.5 Mpa
Pump body	: Aluminium
Diaphragm material	: PTFE / CR Backup
Connection thread	: BSPT
Inlet/outlet	: 3/8"
Air connection	: 1/4"
Net / Gross weight	: 1.8 / 3.0 Kg

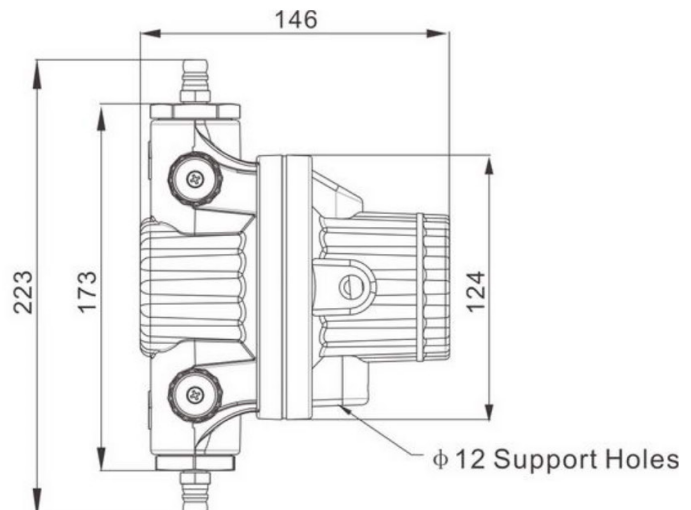
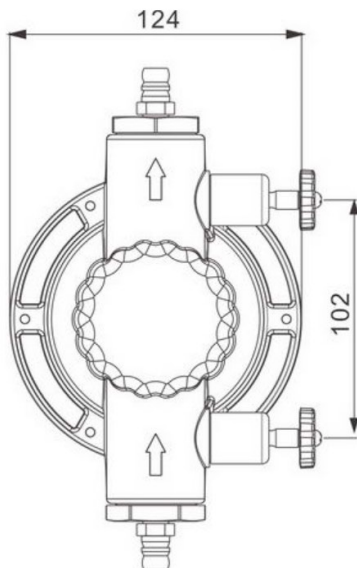

MY-10A

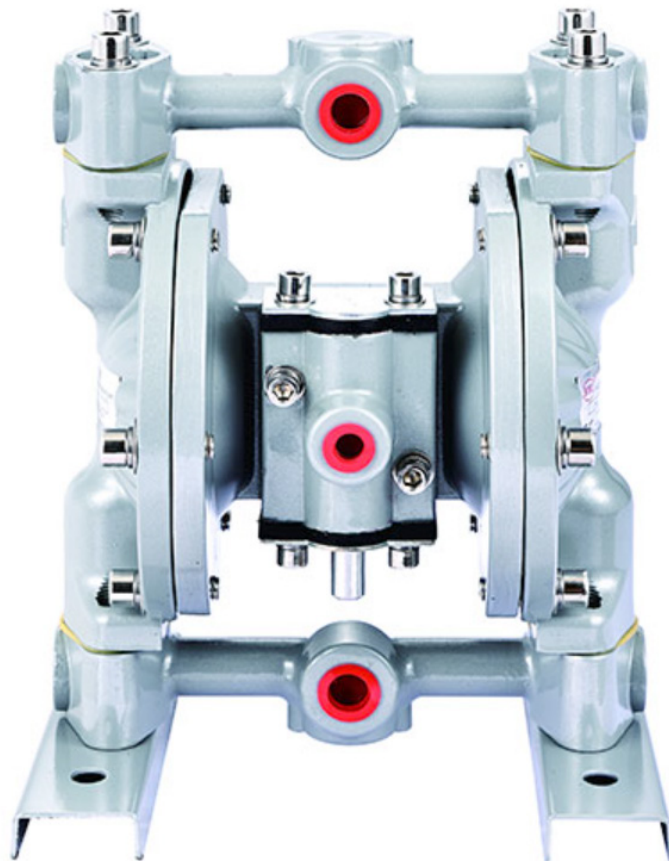
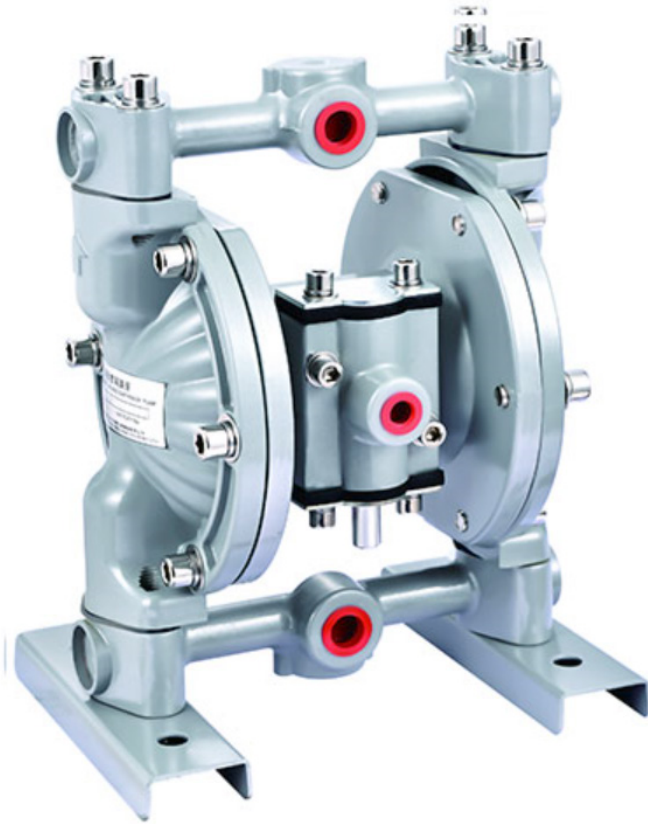

AIR OPERATED DOUBLE DIAPHRAGM PUMP 3/8" ALUMINIUM / PTFE

MY-10A

Technical Data

Capacity (Max)	: 15 l/min
Suction lift (Max)	: 6 mm
Disc. pressure (Max)	: 0.7 Mpa
Solid size pass (Max)	: 2 mm
Air pressure (Max)	: 0.7 Mpa
Pump body material	: Aluminium
Diaphragm material	: PTFE
Connection thread	: BSPT
Inlet/outlet	: 3/8"
Air connection	: 1/4"
Net / Gross weight	: 3.5 / 3.7 Kg
Carton dimension	: 210 x 155 x 255 mm

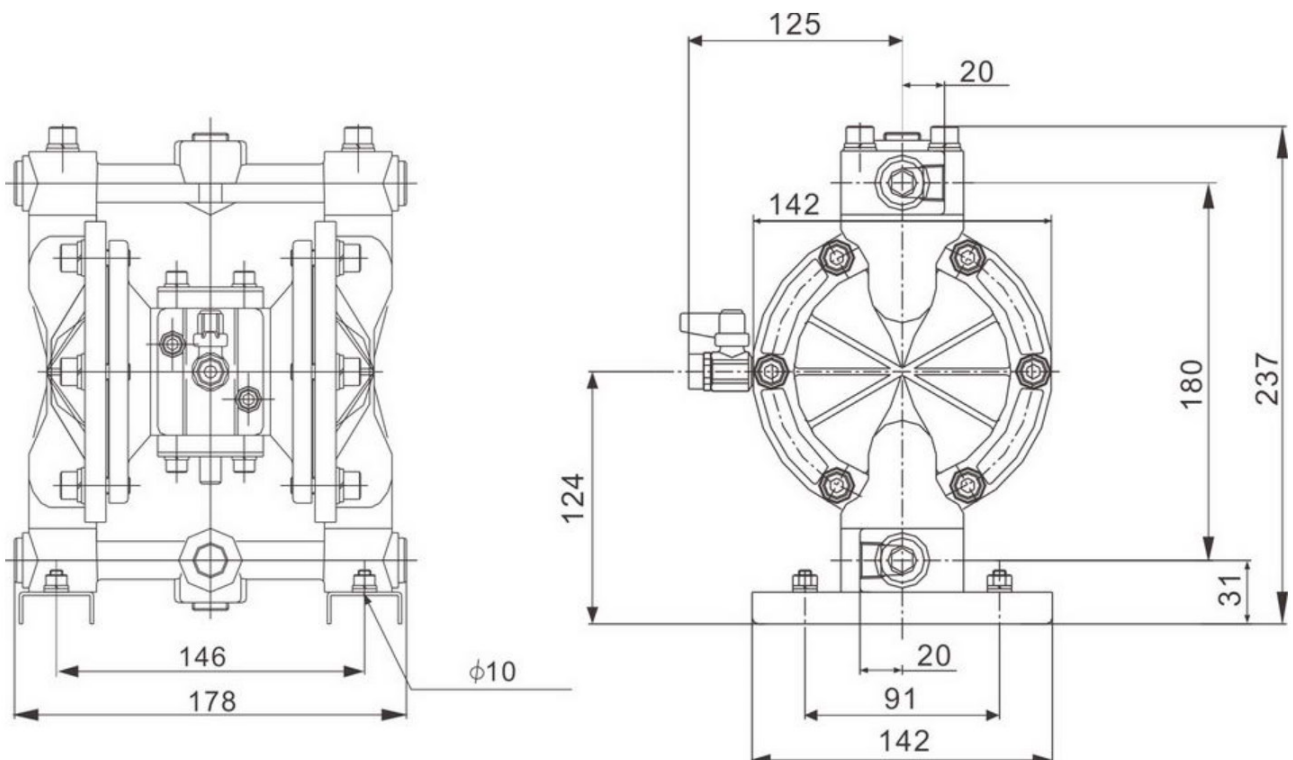

MG-15P



AIR OPERATED DOUBLE DIAPHRAGM PUMP

1/2" Polypropylene / PTFE

MG-15P

Technical Data

Capacity (Max)	: 57 L/min
Suction lift (Max)	: 3.7 m
Disc pressure (Max)	: 0.7 Mpa
Solid size pass (Max)	: 2.5 mm
Air pressure (Max)	: 0.7 Mpa
Pump body material	: PP
Diaphragm material	: PTFE / Santoprene
Connection thread	: BSPT
Inlet/outlet	: 1/2" x 3/4"
Air connection	: 1/4"
Net / Gross weight	: 2.9 / 3.5 Kg
Carton dimension	: 270 x 190 x 290 mm

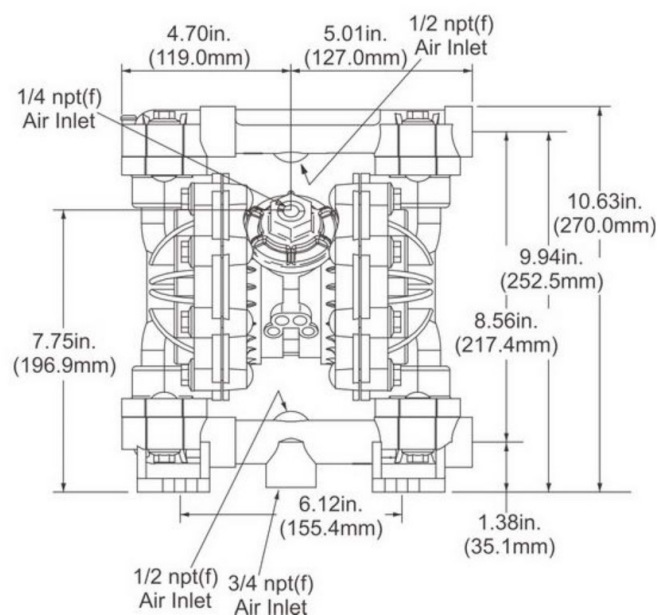
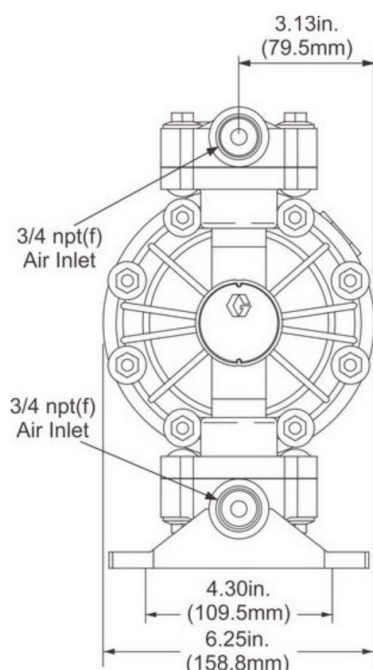

MT-15A



AIR OPERATED DOUBLE DIAPHRAGM PUMP 1/2” Aluminium / PTFE

MT-15A

Technical Data

Capacity (Max)	: 35 l/min
Suction lift (Max)	: 6 m
Disc pressure (Max)	: 0.7 Mpa
Solid size pass (Max)	: 2mm
Air pressure (Max)	: 0.7 Mpa
Pump body material	: Aluminium
Diaphragm material	: PTFE / CR backup
Connection thread	: BSPT
Inlet/outlet	: 1/2” x 1/2”
Air connection	: 1/4”
Net / Gross weight	: 4.5 / 5.0 Kg
Carton dimension	: 180 x 220 x 180 mm

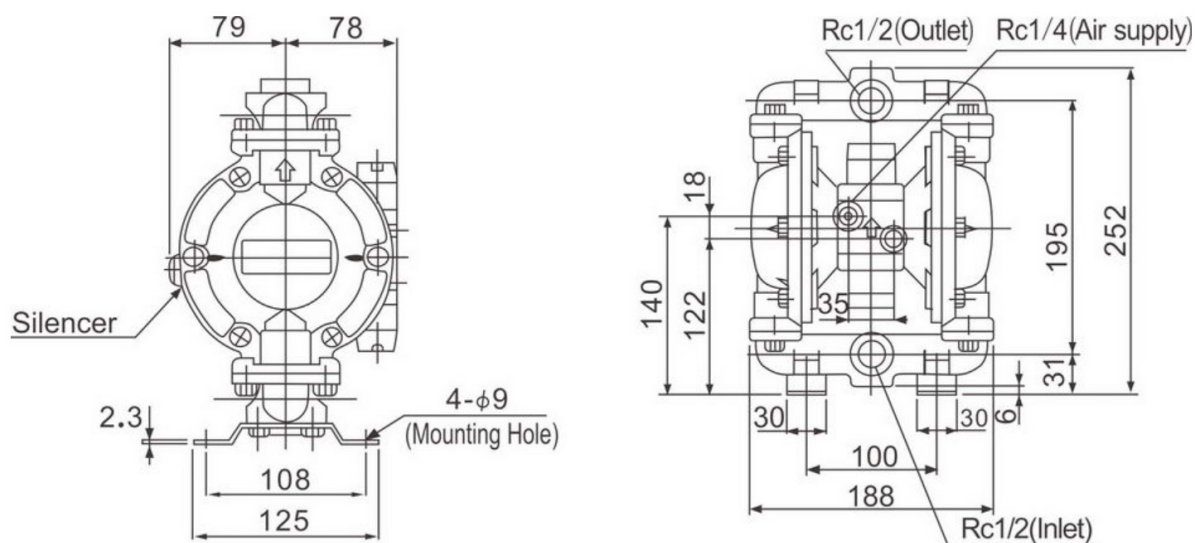



AIR OPERATED DOUBLE DIAPHRAGM PUMP 3/4" Aluminium / PTFE

MT-20A

Technical Data

Capacity (Max)	: 54 l/min
Suction lift (Max)	: 6 m
Disc pressure (Max)	: 0.7 Mpa
Solid size pass (Max)	: 3 mm
Air pressure (Max)	: 0.7 Mpa
Pump body material	: Aluminium
Diaphragm material	: PTFE / CR backup
Connection thread	: BSPT
Inlet/outlet	: 3/4" x 3/4"
Air connection	: 1/4"
Net / Gross weight	: 6.0 / 6.5 Kg
Carton dimension	: 200 x 230 x 320 mm

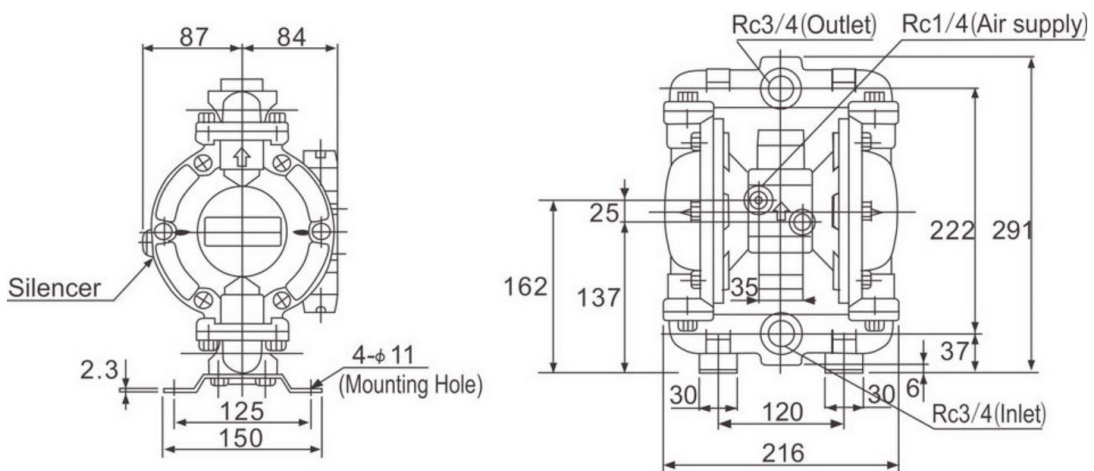

MT-25A

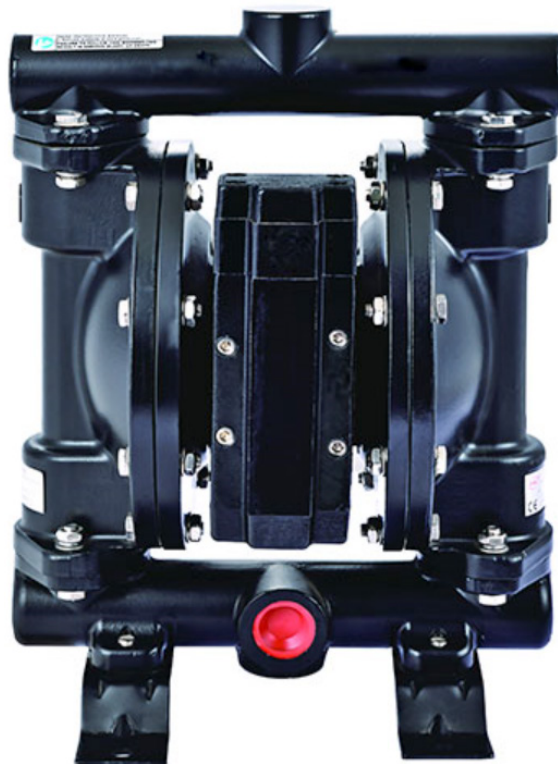

AIR OPERATED DOUBLE DIAPHRAGM PUMP

1" Aluminium / PTFE

MT-25A

Technical Data

Capacity (Max)	: 160 l/min
Suction lift (Max)	: 6 m
Disc pressure (Max)	: 0.7 Mpa
Solid size pass (Max)	: 3 mm
Air pressure (Max)	: 0.7 Mpa
Pump body material	: Aluminium
Diaphragm material	: PTFE / CR backup
Connection thread	: BSPT
Inlet/outlet	: 1"
Air connection	: 3/8"
Net / Gross weight	: 14.0 / 14.5 Kg
Carton dimension	: 240 x 300 x 450 mm

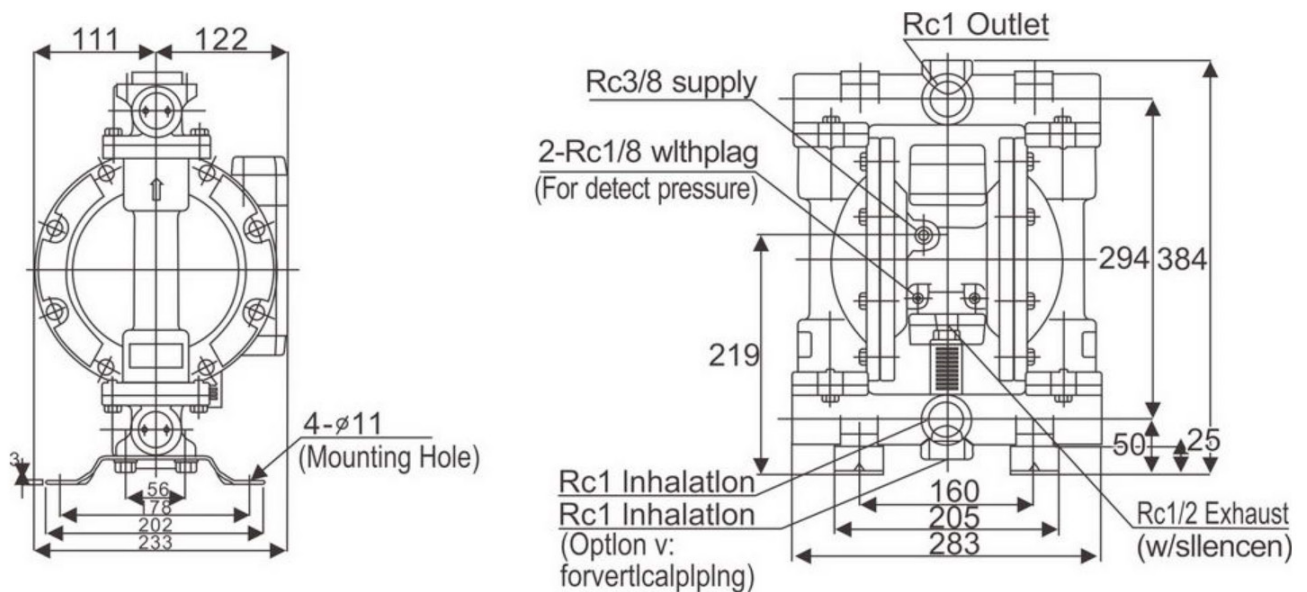

MG-25A



AIR OPERATED DOUBLE DIAPHRAGM PUMP 1" Aluminium

MG-25A

Technical Data

Capacity (Max)	: 160 l/min
Suction lift (Max)	: 4.9 m (dry) : 8.8 m (wet)
Disc pressure (Max)	: 0.8 Mpa
Solid size pass (Max)	: 3.2 mm
Air pressure (Max)	: 0.8 Mpa
Pump body material	: Aluminium
Diaphragm material	: PTFE, Hytrel, Santoprene
Connection thread	: BSPT
Inlet/outlet	: 1"
Air connection	: 1/2"
Net / Gross weight	: 7.7 / 8.2 Kg
Carton dimension	: 360 x 230 x 480 mm

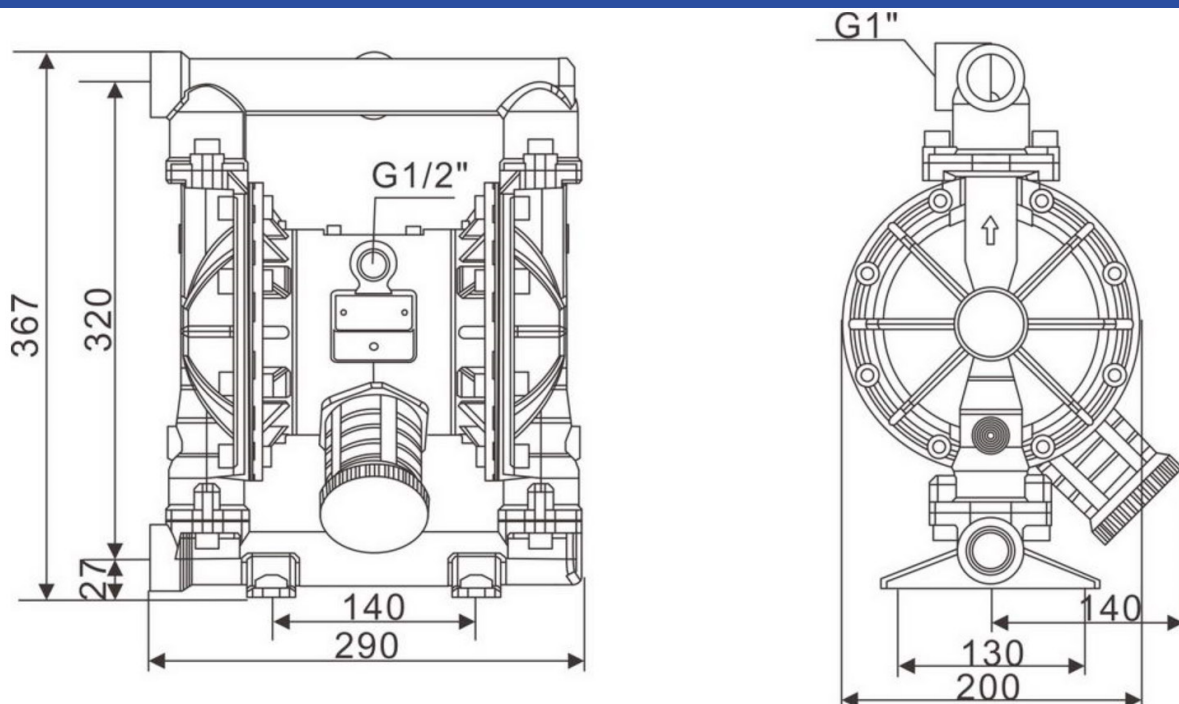

MG-25P



AIR OPERATED DOUBLE DIAPHRAGM PUMP 1" Polypropylene

MG-25P

Technical Data

Capacity (Max)	: 160 l/min
Suction lift (Max)	: 4.9 m (dry) : 8.8 m (wet)
Disc pressure (Max)	: 0.8 Mpa
Solid size pass (Max)	: 3.2mm
Air pressure (Max)	: 0.8 Mpa
Pump body material	: Polypropylene
Diaphragm material	: PTFE, Hytrel, Santoprene
Connection	: Flange
Inlet/outlet	: 1"
Air connection	: 1/2"
Net / Gross weight	: 7.8 / 8.3 Kg
Carton dimension	: 360 x 230 x 480 mm

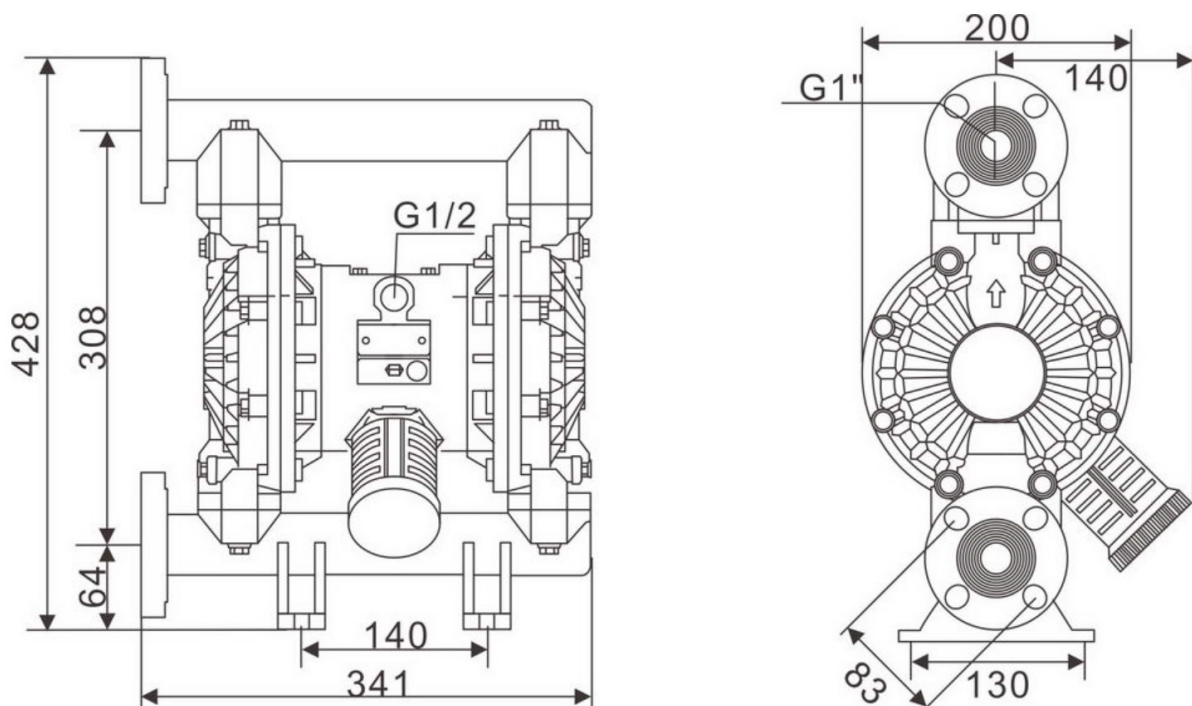

MG-25S

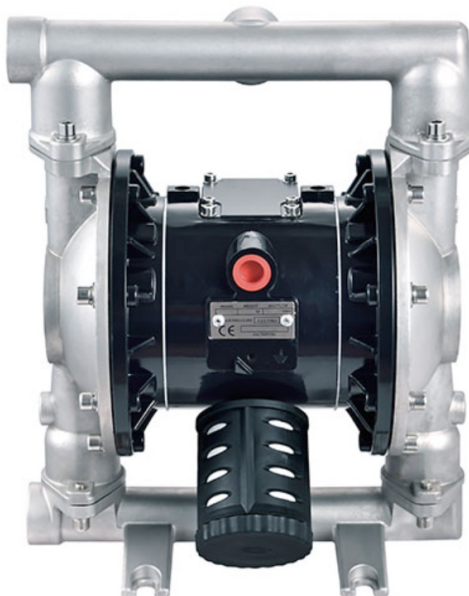

AIR OPERATED DOUBLE DIAPHRAGM PUMP

1" Stainless steel

MG-25S

Technical Data

Capacity (Max)	: 160 l/min
Suction lift (Max)	: 4.9 m (dry)
	: 8.8 m (wet)
Disc pressure (Max)	: 0.8 Mpa
Solid size pass (Max)	: 3.2 mm
Air pressure	: 0-2-0.8 Mpa
Pump body material	: Stainless steel 304
Diaphragm material	: PTFE, Hytrel, Santoprene
Connection thread	: BSPT
Inlet/outlet	: 1"
Air connection	: 1/2"
Net / Gross weight	: 13.5 / 14.0 Kg
Carton dimension	: 360 x 230 x 480 mm

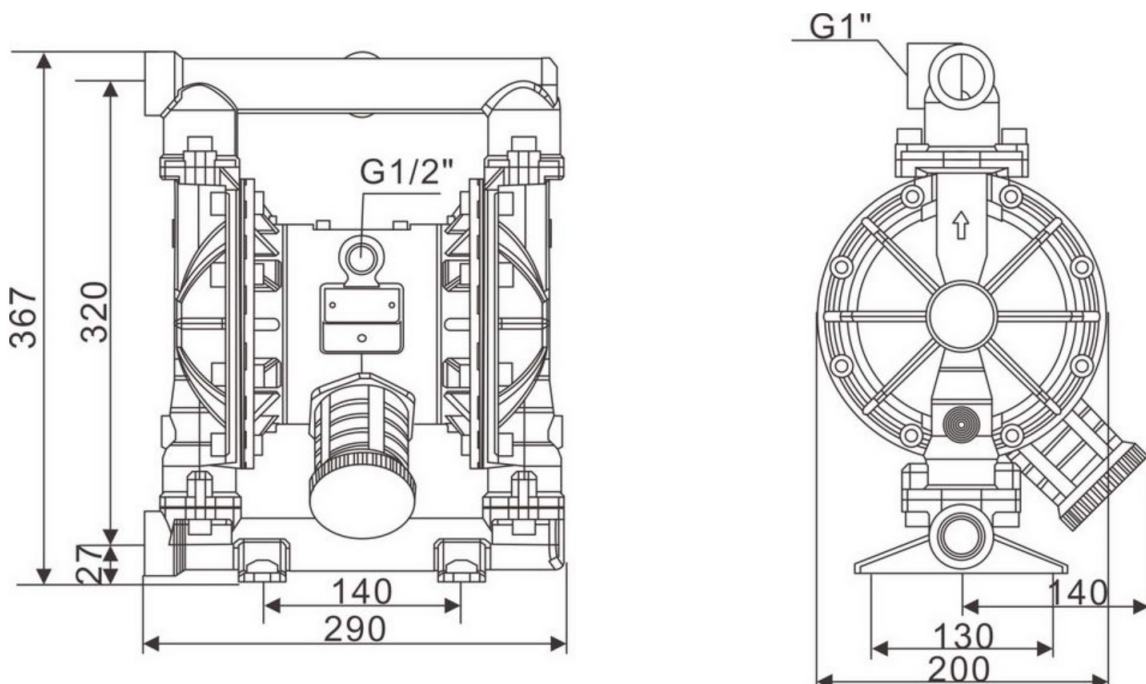

MG-40A



AIR OPERATED DOUBLE DIAPHRAGM PUMP 1-1/2" Aluminium

MG-40A

Technical Data

Capacity (Max)	: 379 l/min
Suction lift (Max)	: 6.1 m
Disc pressure (Max)	: 0.8 Mpa
Solid size pass (Max)	: 4.8 mm
Air pressure	: 0-2-0.8 Mpa
Pump body material	: Aluminium
Diaphragm material	: PTFE, Hytrel, Santoprene
Connection thread	: BSPT
Inlet/outlet	: 1-1/2" x 1-1/2"
Air connection	: 1/2"
Net weight	: 16.0 Kg
Carton dimension	: 275 x 400 x 540 mm

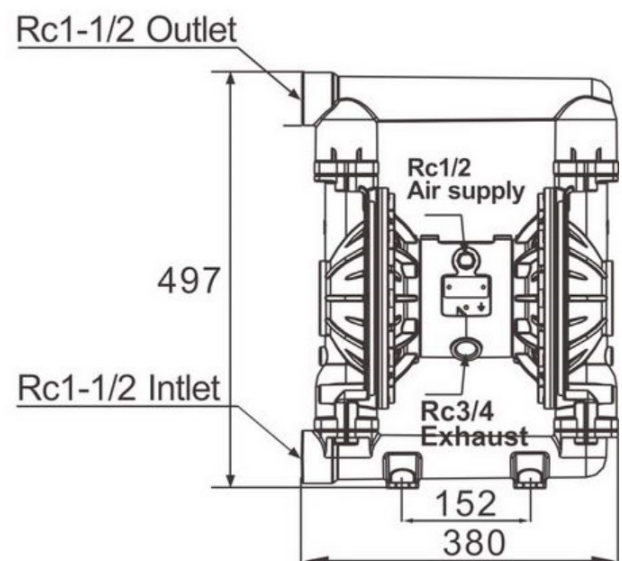
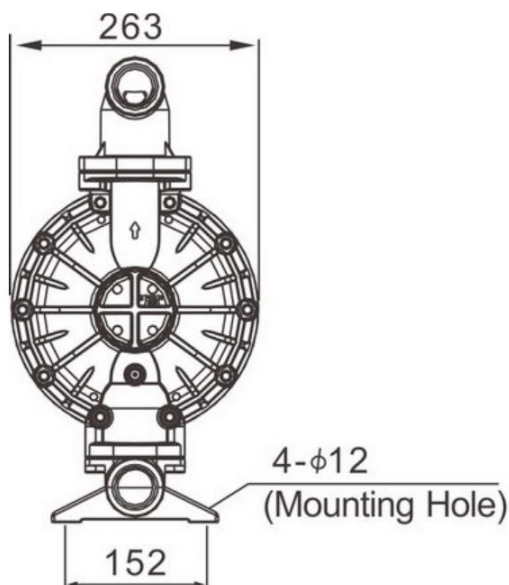



AIR OPERATED DOUBLE DIAPHRAGM PUMP

1-1/2" Ductile iron

MG-40D

Technical Data

Capacity (Max)	: 379 l/min
Suction lift (Max)	: 6.1 m
Disc pressure (Max)	: 0.8 Mpa
Solid size pass (Max)	: 4.8 mm
Air pressure	: 0-2-0.8 Mpa
Pump body material	: Ductile iron
Diaphragm material	: PTFE, Hytrel, Santo- prene
Connection thread	: BSPT
Inlet/outlet	: 1-1/2" x 1-1/2"
Air connection	: 1/2"
Net weight	: 38.0 Kg
Carton dimension	: 440 x 310 x 640 mm

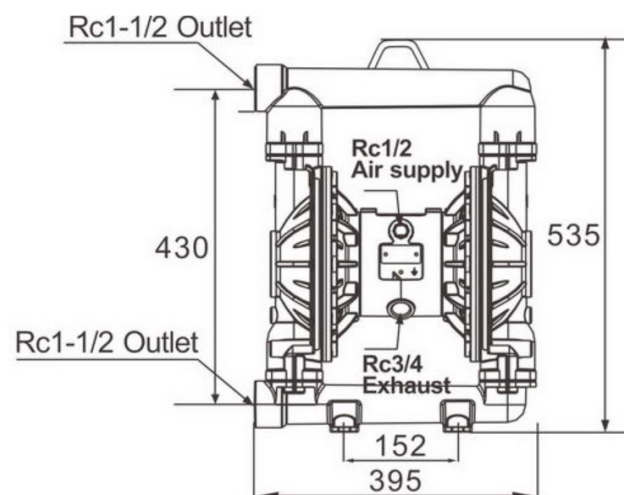
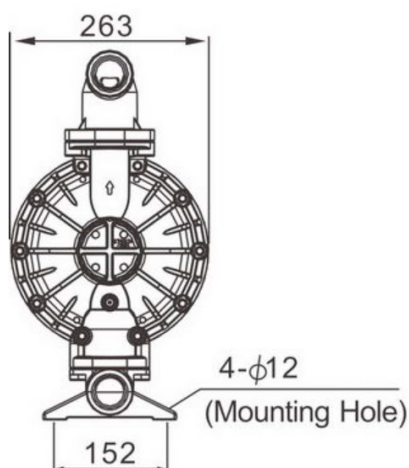

MG-40P

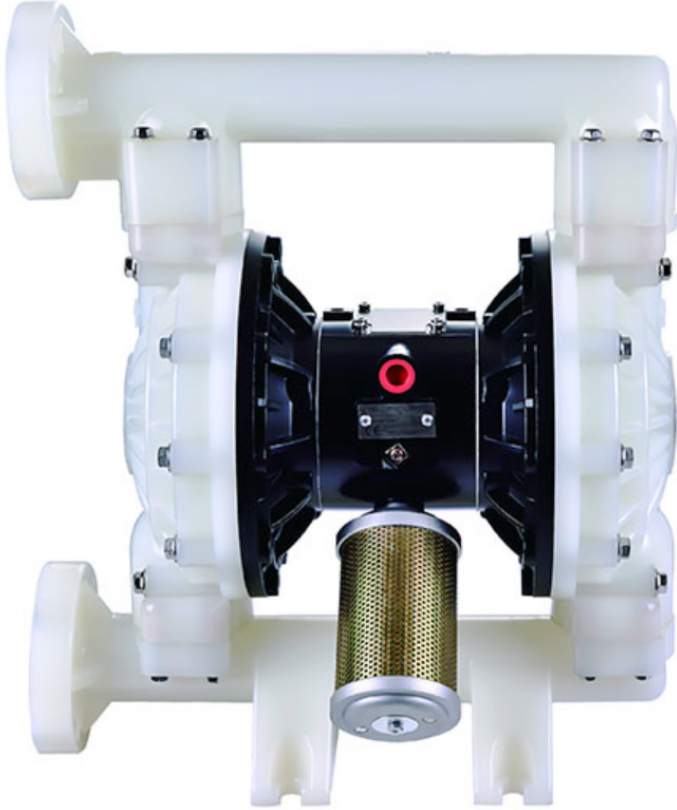

AIR OPERATED DOUBLE DIAPHRAGM PUMP

1-1/2" Polypropylene

MG-40P

Technical Data

Capacity (Max)	: 379 l/min
Suction lift (Max)	: 6.1 m
Disc pressure (Max)	: 0.8 Mpa
Solid size pass (Max)	: 4.8 mm
Air pressure	: 0-2-0.8 Mpa
Pump body material	: Ductile iron
Diaphragm material	: PTFE, Hytrel, Santoprene
Connection	: Flange
Inlet/outlet	: 1-1/2" x 1-1/2"
Air connection	: 1/2"
Net weight	: 16.0 Kg
Carton dimension	: 470 x 280 x 590 mm

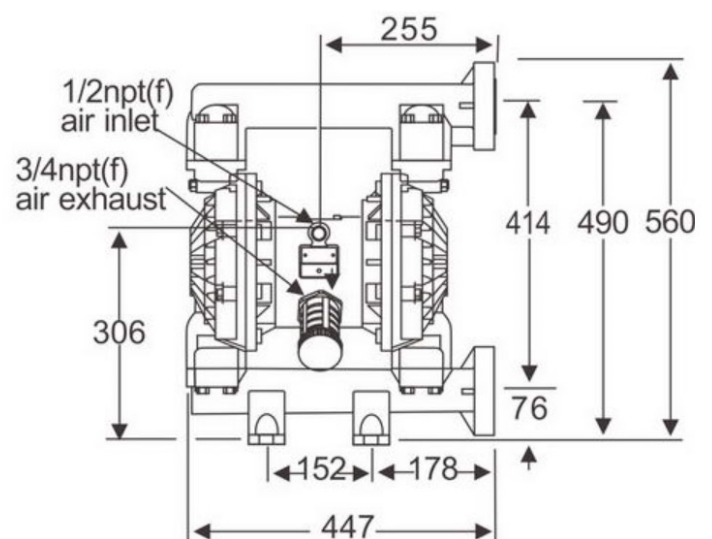
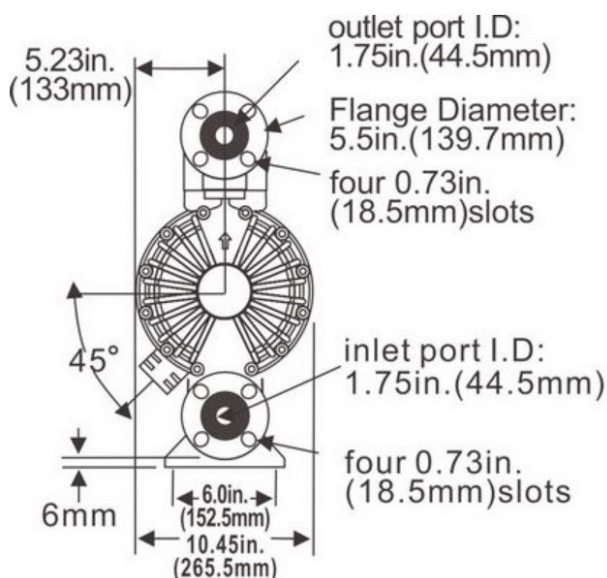

MG-40S



AIR OPERATED DOUBLE DIAPHRAGM PUMP

1-1/2" Stainless steel

MG-40S

Technical Data

Capacity (Max)	: 379 l/min
Suction lift (Max)	: 6.1 m
Disc pressure (Max)	: 0.8 Mpa
Solid size pass (Max)	: 4.8 mm
Air pressure	: 0-2-0.8 Mpa
Pump body material	: SS304
Diaphragm material	: PTFE, Hytrel, Santoprene
Connection thread	: BSPT
Inlet/outlet	: 1-1/2" x 1-1/2"
Air connection	: 1/2"
Net weight	: 29.0 Kg
Carton dimension	: 275 x 400 x 540 mm

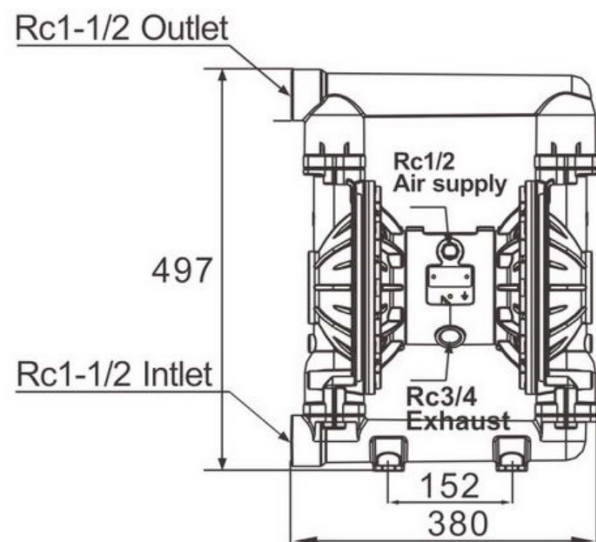
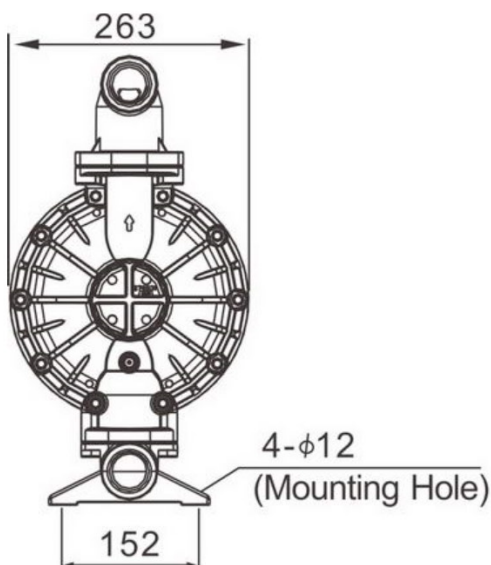



AIR OPERATED DOUBLE DIAPHRAGM PUMP

2" Aluminium

MG-50A

Technical Data

Capacity (Max)	: 568 l/min
Suction lift (Max)	: 6.1 m
Disc pressure (Max)	: 0.8 Mpa
Solid size pass (Max)	: 6.3 mm
Air pressure	: 0-2-0.8 Mpa
Pump body material	: Aluminium
Diaphragm material	: PTFE, Hytrel, Santoprene
Connection thread	: BSPT
Inlet/outlet	: 2" x 2"
Air connection	: 1/2"
Net weight	: 23.0 Kg
Carton dimension	: 340 x 460 x 640 mm

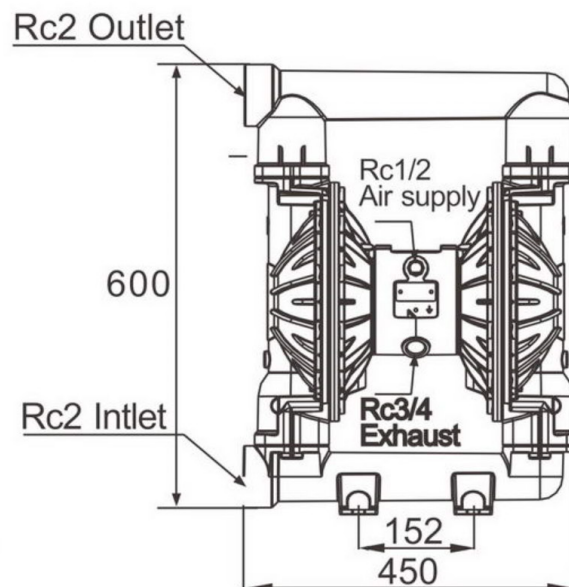
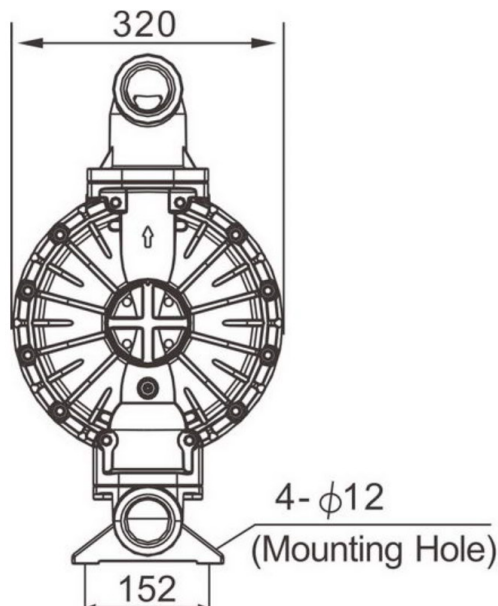

MG-50D



AIR OPERATED DOUBLE DIAPHRAGM PUMP

2" Ductile iron

MG-50D

Technical Data

Capacity (Max)	: 568 l/min
Suction lift (Max)	: 6.1 m
Disc pressure (Max)	: 0.8 Mpa
Solid size pass (Max)	: 6.3 mm
Air pressure	: 0-2-0.8 Mpa
Pump body material	: Ductile iron
Diaphragm material	: PTFE, Hytrel, Santoprene
Connection thread	: BSPT
Inlet/outlet	: 2" x 2"
Air connection	: 1/2"
Net weight	: 56.0 Kg
Carton dimension	: 550 x 390 x 730 mm

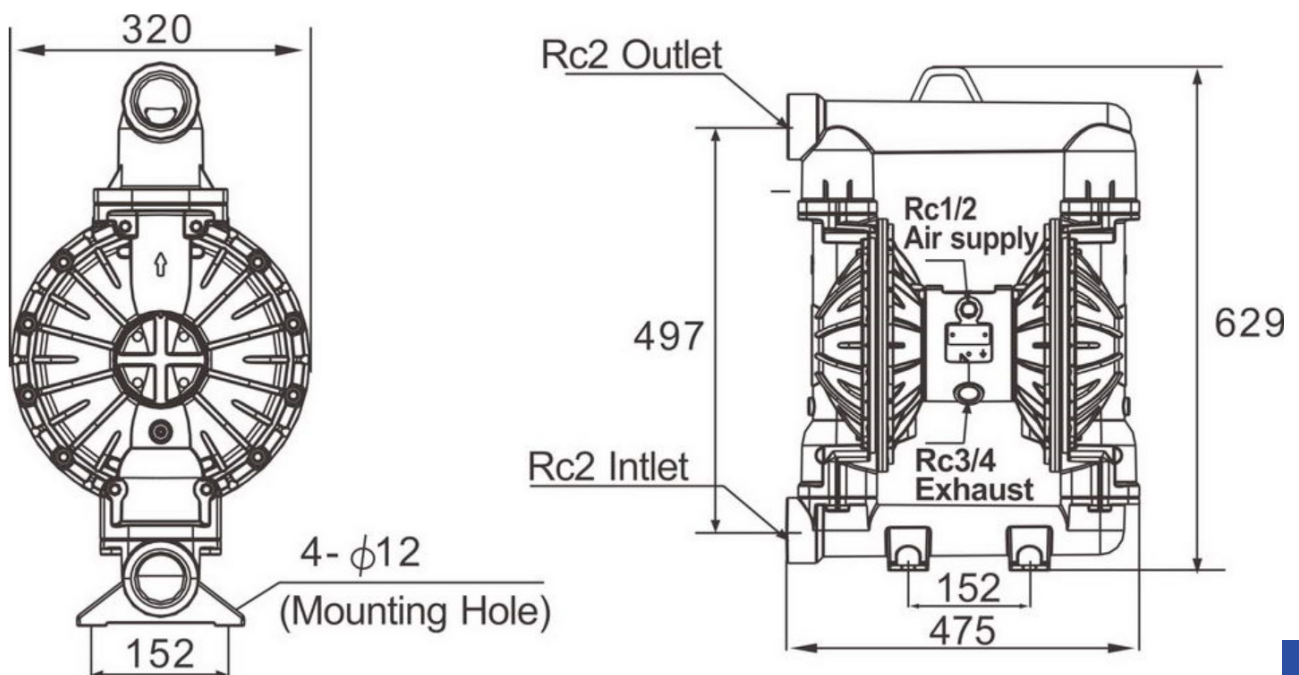

MG-50P

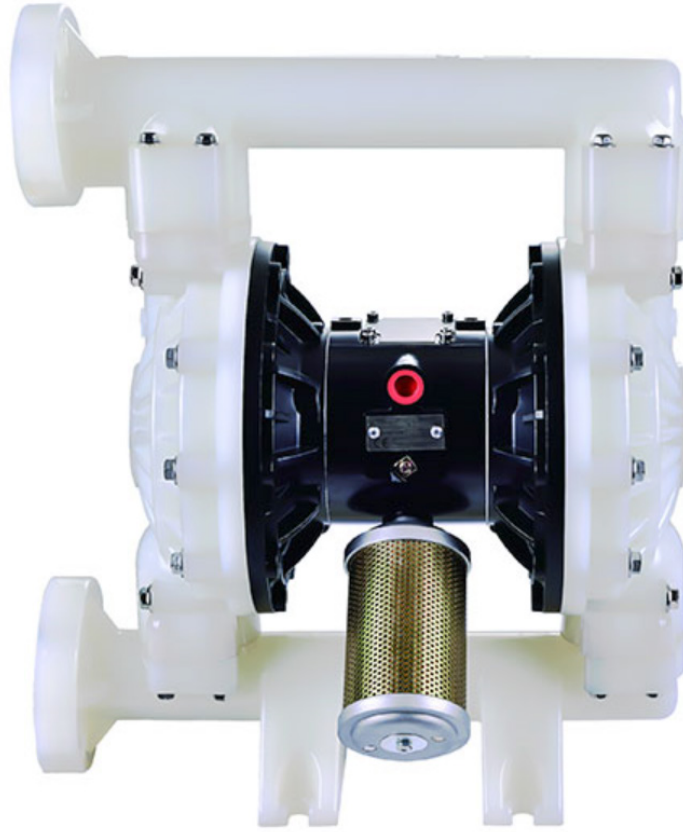

AIR OPERATED DOUBLE DIAPHRAGM PUMP

2" Polypropylene

MG-50P

Technical Data

Capacity (Max)	: 568 l/min
Suction lift (Max)	: 6.1 m
Disc pressure (Max)	: 0.8 Mpa
Solid size pass (Max)	: 6.3 mm
Air pressure	: 0-2-0.8 Mpa
Pump body material	: Polypropylene
Diaphragm material	: PTFE, Hytrel, Santoprene
Connection	: Flange
Inlet/outlet	: 2" x 2"
Air connection	: 1/2"
Net weight	: 22.0 Kg
Carton dimension	: 530 x 350 x 680 mm

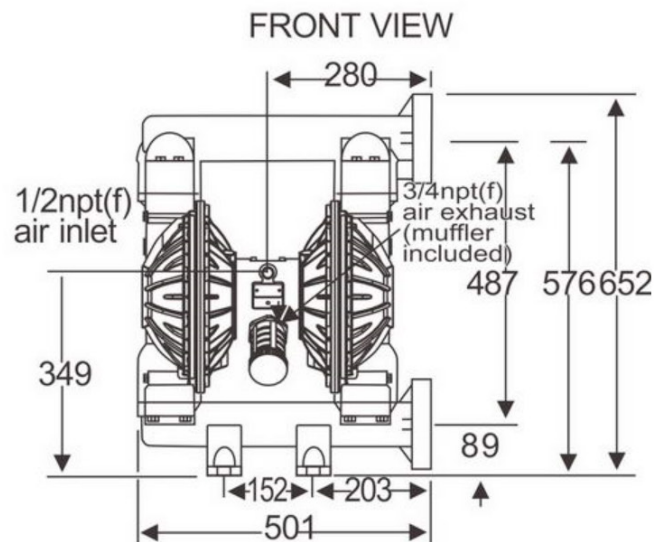
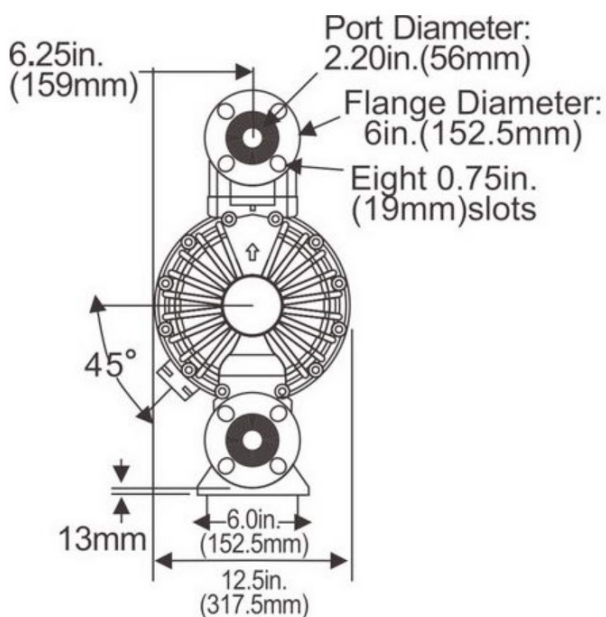

MG-80A



AIR OPERATED DOUBLE DIAPHRAGM PUMP

3" Aluminium

MG-80A

Technical Data

Capacity (Max)	: 1135 l/min
Suction lift (Max)	: 7.0 m
Disc pressure (Max)	: 0.8 Mpa
Solid size pass (Max)	: 12.7 mm
Air pressure	: 0-2-0.8 Mpa
Pump body material	: Aluminium
Diaphragm material	: PTFE, Hytrel, Santoprene
Connection thread	: BSPT
Inlet/outlet	: 3" x 3"
Air connection	: 3/4"
Net / Gross weight	: 68.0 / 76.0 Kg
Carton dimension	: 980 x 800 x 510 mm

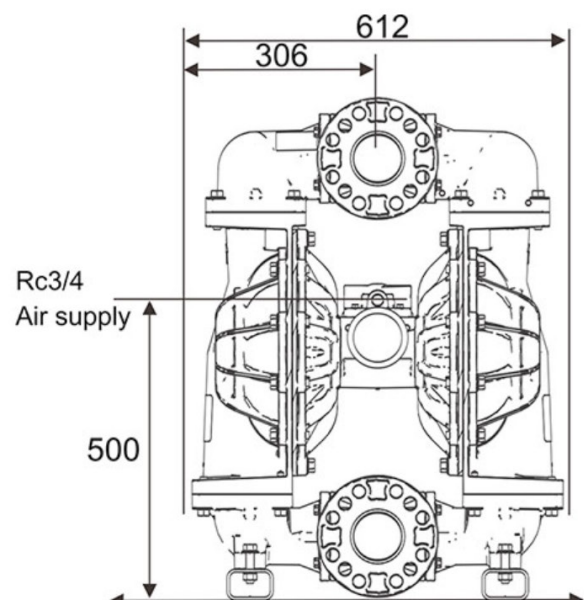
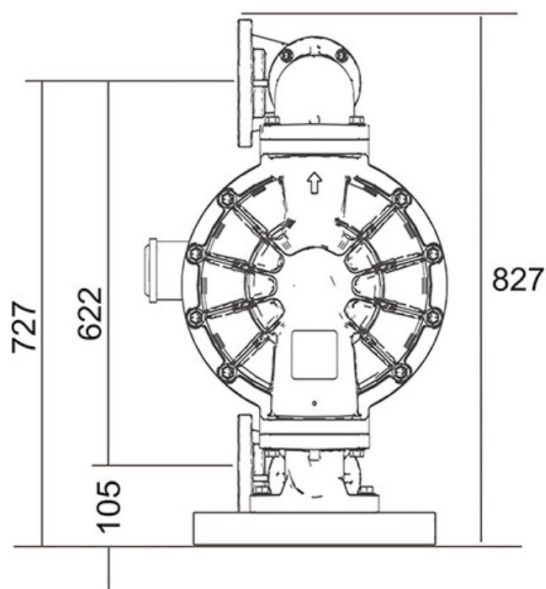

MTX

Distributed By:



Expertise in AODD pump and parts